

Note: Part numbers and standards' values may change. Consult LECO for the latest information.

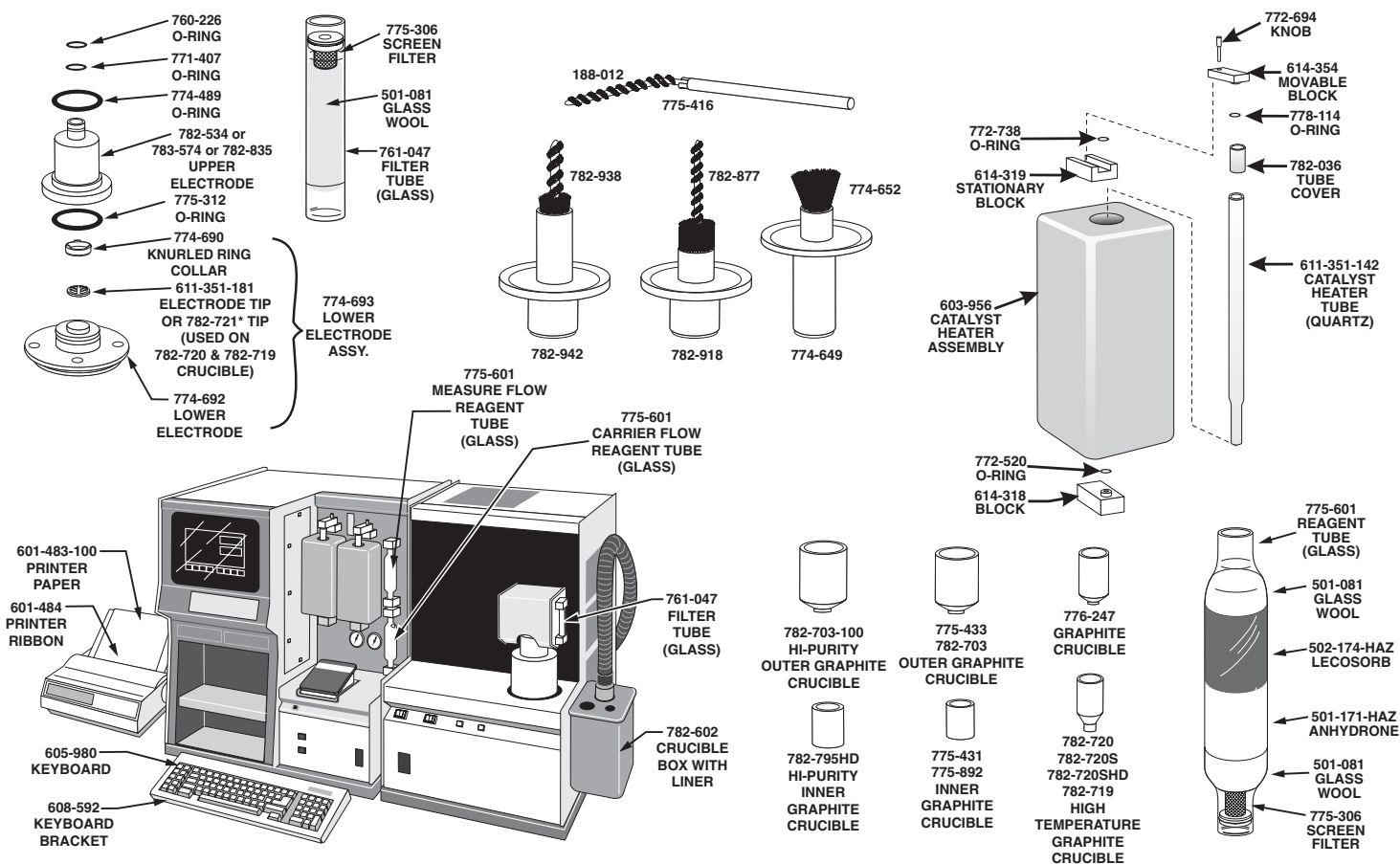

**FUSION SUPPLIES**

- 501-598 Etchable Nibbled Nickel 100 g bottle
- 776-247 Graphite Crucible 1000/pkg
- 501-073 Graphite Powder 100 g bottle
- 782-721\* High Temperature Electrode Insert (required for 782-719 or 782-720 Crucibles)
- 782-719 High Temperature Graphite Crucible 50/pkg
- 782-720 High Temperature Graphite Crucible, 0.5" OD, 1000/pkg
- 782-720S High Temperature Graphite Crucible, 0.625" OD, 1000/pkg
- 782-720SHD High Density Graphite Crucible, 0.5" OD, 1000/pkg
- 782-795HD Inner Crucible (Hi-Purity) 1000/pkg
- 780-890 Graphite Crucible 1000/pkg
- 775-431 Inner Graphite Crucible 1000/pkg
- 775-892 Inner Graphite Crucible 100/pkg
- 780-892 Graphite Crucible Cover 1000/pkg
- 502-040 Large Tin Capsule 100/bottle
- 774-693 Lower Electrode Assembly, requires 775-312 O-ring, includes: 774-692 Electrode, 611-351-181 Electrode Tip, 774-690 Knurled Ring (Collar)
- 502-183 Nickel Capsule 100/bottle
- 763-029 1.5 g Nickel Baskets 100/bottle
- 502-345 1.5 g Nickel Baskets Ultra High Purity 100/bottle
- 502-344 1.0 g Nickel Baskets Ultra High Purity 100/bottle
- 775-433 Outer Graphite Crucible 50/pkg
- 782-703 Outer Graphite Crucible 1000/pkg
- 501-059 Small Tin Capsule 100/bottle
- 782-534 Upper Electrode (for standard EF400 Furnace; w/o sensor) requires 774-489 O-ring, 771-407 O-ring, and 760-226 O-ring

**FUSION SUPPLIES (continued)**

- 783-574 Upper Electrode (for EF400EN furnace; w/o sensor) requires 774-489 O-ring, 774-613 O-ring, and 760-226 O-ring
- 782-835 Upper Electrode (for EF400 Furnace with optical sensor) requires 774-489 O-ring, 771-407 O-ring, and 760-226 O-ring

**CATALYSTS AND REAGENTS**

- 501-171-HAZ Anhydrone 454 g (1 lb.) bottle
- 502-189 Copper Sticks 100 g ampule
- 502-304 Copper Sticks 100 g bottle
- 502-304-500 Copper Sticks 500 g bottle
- 501-621 Copper Turnings 200 g bottle
- 501-081 Glass Wool 454 g (1 lb.) box
- 501-073 Graphite Powder 100 g bottle
- 502-174-HAZ Lecosorb 500 g bottle, 20-30 mesh
- 502-176-HAZ Lecosorb 500 g bottle, 8-20 mesh
- 501-170 Rare Earth Copper Oxide 50 g bottle

**CLEANING BRUSHES**

- 774-649 Cleaning Brush Assembly (replacement brush, 774-652)
- 775-416 Cleaning Brush Assembly (replacement brush, 188-012)
- 782-918 Cleaning Brush Assembly (replacement brush, 782-877)
- 782-942 Cleaning Brush Assembly (replacement brush, 782-938)
- 783-301 Lower Cleaning Brush (use with EF-500)
- 619-803 Upper Cleaning Brush (use with EF-500)

\*Not part of 774-693 Assembly

See reverse side for contact information

**REAGENT TUBES**

611-351-142 Quartz Catalyst Tube, two (2) 772-520, 778-114  
O-rings required for sealing  
761-047 Glass Tube, two (2) 772-520 O-rings required for  
sealing  
775-601 Glass Tube, two (2) 772-520 O-rings required for  
sealing

**OPERATION ACCESSORIES**

768-980 Balston Filter  
766-053 Crucible Tweezers  
766-646 Air Filter Coating  
775-306 Secondary Filter, 10 micron  
775-307 Screen Filter Removal Tool  
775-850 Halogen Trap Kit  
765-933 Lubricool Cooling Agent  
764-078 One gram Weight  
783-786-HAZ Oxygen and Moisture Removal Kit  
783-785-110-HAZ Replacement Tube for 783-786-HAZ Kit  
601-483 Printer Paper  
601-484 Printer Ribbon  
760-138 Sample Tweezers  
501-241 Vacuum Grease  
767-473 Utility Funnel  
782-880 Vacuum Cleaner Filter

**CALIBRATION SAMPLES****STEEL PINS (0.5 gram pin-100/bottle)**

Part No.	ppm Nitrogen	ppm Oxygen
501-550	15-45	15-45
502-102	200-250	25-55
502-494	300-600	30-80

**(1 gram pin-100/bottle)**

Part No.	ppm Nitrogen	ppm Oxygen
501-643	15-45	15-45
501-644	50-100	50-150
501-645	250-400	150-300
502-193	10-50	—
502-194	65-150	—
502-195	175-300	—
502-197	—	10-50
502-198	—	65-150
502-257	300-600	25-75
502-328	300-600	—

**(1 gram pin-454/bottle)**

Part No.	ppm Nitrogen	ppm Oxygen
501-643-100	15-45	15-45

**CALIBRATION SAMPLES (cont'd)****TITANIUM PINS (0.1 gram pin-100/bottle)**

Part No.	% Nitrogen	% Oxygen
501-653	0.002-0.005	0.040-0.050
501-657	0.005-0.009	0.070-0.085
501-664	0.012-0.020	0.14-0.16
501-320	0.012-0.020	0.16-0.25
502-201	0.017-0.020	0.250-0.270

**HIGH NITROGEN STEEL PINS (0.5 gram pin-100/bottle)**

Part No.	% Nitrogen
502-016	0.15-0.25
502-072	0.50-0.55

**COPPER PINS (1 gram pin-100/bottle)**

Part No.	ppm Oxygen
501-147	175-325
501-148	325-475
501-149	475-700

**ZIRCONIUM PINS (0.1 gram pin-100/bottle)**

Part No.	% Oxygen
502-047	0.125-0.135

**HIGH OXYGEN STANDARDS (10 gram bottle-powder)**

Part No.	% Oxygen
502-138 Iron Oxide III	29.5-30.5
502-139 Silicon Dioxide	53.3
502-140 Zirconium Oxide	25.7-26.3
502-141 Tungsten Trioxide	18.8-20.6

**IRON POWDER (35 gram bottle)**

Part No.	% Oxygen	% Nitrogen
502-399	1.09%	0.0067%

**IRON CHIP (50 g/bottle)**

Part No.	Carbon/Sulfur/Nitrogen
502-401	<5 ppm

**NICKEL PIN (1 g pin-100 g bottle)**

Part No.	ppm Oxygen
502-411	2-8

**STEEL PIN (1 g pin-100 g bottle)**

Part No.	ppm Nitrogen	ppm Oxygen	ppm Hydrogen
502-416	300-600	25-75	1-6

*NOTE: Part numbers and standards' values may change. Consult LECO for latest information.*

*Please Note: Quartz Tubes are typically utilized for higher temperature applications (i.e. catalyst tubes). Glass reagent/filter tubes are designed for lower temperature applications. Glass tubes should not be used in place of quartz tubes.*

**United States:**

Ph: 1-800-292-6141  
Fax: 269-982-8977

**Canada:**

Ph: 1-800-268-0215  
Fax: 905-564-6582

represented by:

**Other Countries:**

Ph: 269-983-5531  
Fax: 269-983-3850

© 2010 LECO Corporation