

SC-144 Series Consumables & Spare Parts Reference Card

Note: Part numbers and standards' values may change. Consult LECO for the latest information.

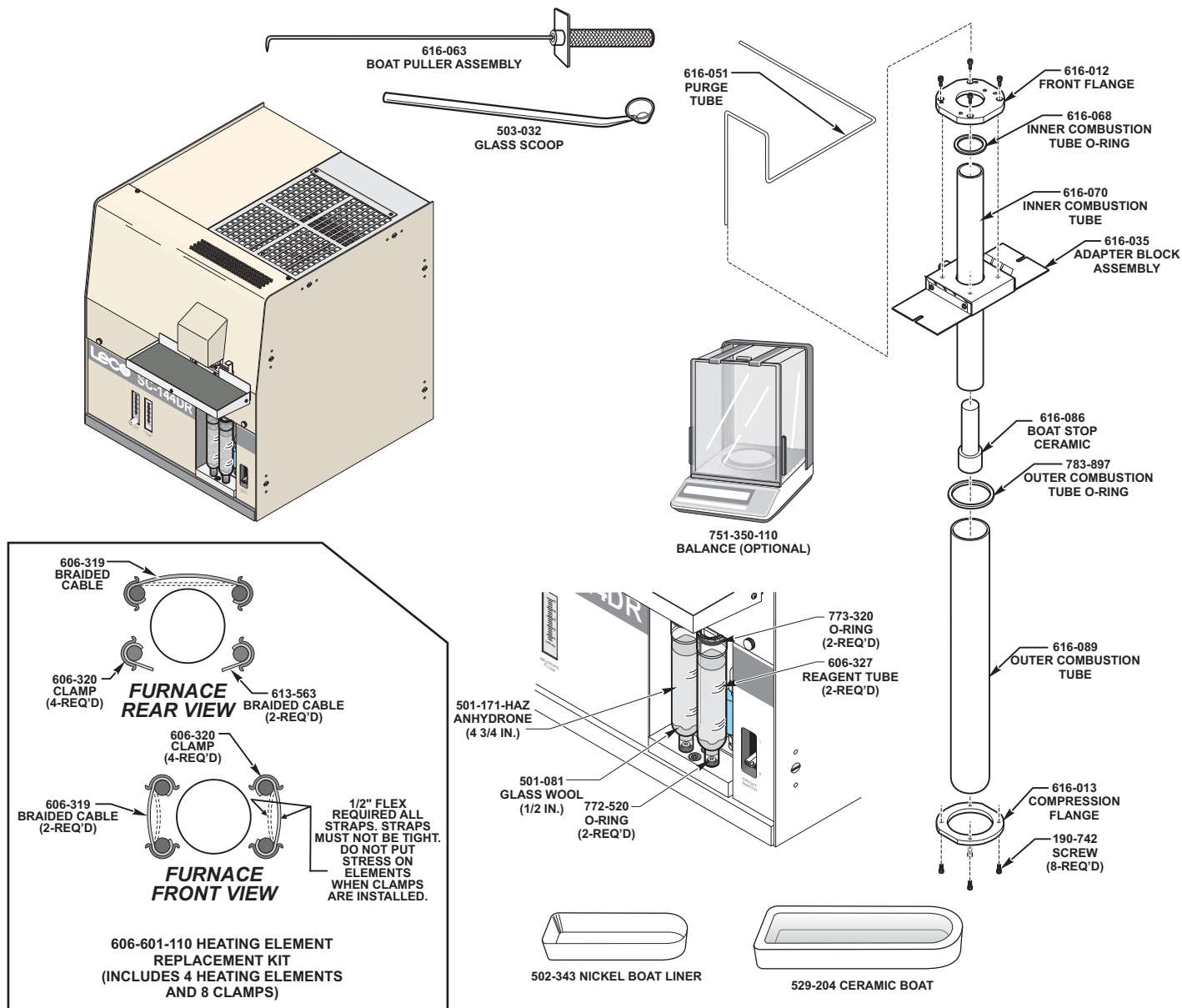

GENERAL COMBUSTION SUPPLIES

- 501-171-HAZ Anhydrones 454 g (1 lb. bottle)
- 769-608 Antimony Metal 200 g bottle (used for removal of fluorine and chlorine)
- 616-086 Boat Stop Stepped Ceramic
- 501-426 ComAid™ for Solids 454 g (1 lb.) bottle
- 501-427 ComAid™ for Liquids 454 g (1 lb.) bottle
- 502-321 COM-CAT 250 g bottle
- 529-204 Combustion Boat - Ceramic 50/package
- 529-204-250 Combustion Boat - Ceramic 250/package
- 769-610 F-CL Absorbent Material 225 g bottle
- 501-081 Glass Wool 454 g (1 lb.) package
- 763-265 Glass Wool 277 g (0.5 lb.) package
- 502-351 Halogen Scrubber 50 g bottle
- 502-343 Nickel Boat Liner 100/package
- 616-051 Purge Tube

GENERAL COMBUSTION SUPPLIES (cont'd.)

- 502-301 Tungsten Trioxide Powder 125 g bottle

COMBUSTION TUBES/GLASSWARE

- 616-070 Inner Combustion Tube, requires one (1) 616-068 O-ring, and one (1) 616-086 Boat Stop, Ceramic
- 616-089 Outer Combustion Tube, requires one (1) 783-897 O-ring
- 606-327 Reagent Tube, requires one (1) 773-320 Top O-ring, and one (1) 772-520 Bottom O-ring

See reverse side for contact information

OPERATION ACCESSORIES

606-403 Adapter Brush	502-023 Funnel
619-591-699 Particle Filter	776-978 Glass Scoop, Large
613-563 Braided Cables (Short Strap)	503-032 Glass Scoop, Regular
606-319 Braided Cable	606-601-110 Heating Element Kit
606-320 Clamps	606-316 Outlet Port Adapter
761-929 Crucible Tongs	501-241 Vacuum Grease
175-590 Diaphragm & Flapper Valve Kit (for Pump)	501-614 Spatula
613-564 Expansion Tool for T-Clamps	606-224 Thermocouple
	789-431-HAZ 5K Consum Pkg.

REFERENCE MATERIALS

COAL (50 grams)

Part No.	% Sulfur**
502-670	~0.5
502-671	~1.0
502-672	~2.0
502-673	~3.0
502-674	~4.5

RESIDUAL FUEL OILS (100 mL)

Part No.	% S**
502-848	~0.25
502-849	~1.0
502-850	~3.0

WHITE MINERAL OIL (100 mL)

Part No.	% Sulfur**
502-851	~0.01
502-917	~0.10
502-922	~1.0
502-854	~5.0

CERTIFIED REFERENCE MATERIALS

COAL (50 grams)

Part No.	% S*	Part No.	% S*
502-831	1.5	502-837	3.26
502-832	0.25	502-838	0.7
502-833	0.34	502-839	2.1
502-834	0.30	502-845	0.67
502-835	0.5	502-846	0.70
502-836	3.99		

SET-UP STANDARDS

ZINC SULFIDE (50 grams)

Part No.	% Sulfur
502-699	32.91

SOIL (65 grams)

Part No.	% C	% H	% N**	% S**
502-062	0.75–1.25	**	0.09–0.15	0.015–0.3
502-697	2.50–3.50	—	0.2–0.3	0.015–0.3
502-694	10.0–14.0	—	0.3–1.0	0.015–0.3

TOBACCO LEAVES (20 grams)

Part No.	% C	% H	% N	% S
502-082	35.0–47.0	4.0–7.0	2.0–4.0	0.3–0.8

CORN GLUTEN (50 grams)

Part No.	% C	% H	% N	% S
502-932	51.0–53.0	7.0–7.5	11.0–12.0	0.75–1.0

BBOT (25 grams)

Part No.	% C	% H	% N	% S
502-897	72.2–72.8	6.0–6.2	6.3–6.7	7.3–7.4

ALFALFA (50 grams)

Part No.	% C	% H	% N	% S
502-273	45.0–47.0	5.5–6.5	2.5–5.0	0.25–0.35

WHEAT FLOUR (50 grams)

Part No.	% C	% H	% N	% S
502-692	44.0–46.0	6.0–7.0	2.5–3.5	0.15–0.25

BARLEY FLOUR (50 grams)

Part No.	% C	% H	% N	% S
502-906	45.0–47.0	6.0–7.0	1.0–3.0	0.10–0.20

*Reported on Dry Basis

**Values vary—contact LECO for current levels.

NOTES: Plant tissue samples should be dried at 85°C for two hours; all other samples should be dried at 105°C for one hour.

Part numbers and standards' values may change.
Consult LECO for latest information.