

Note: Part numbers and standards' values may change. Consult LECO for the latest information.

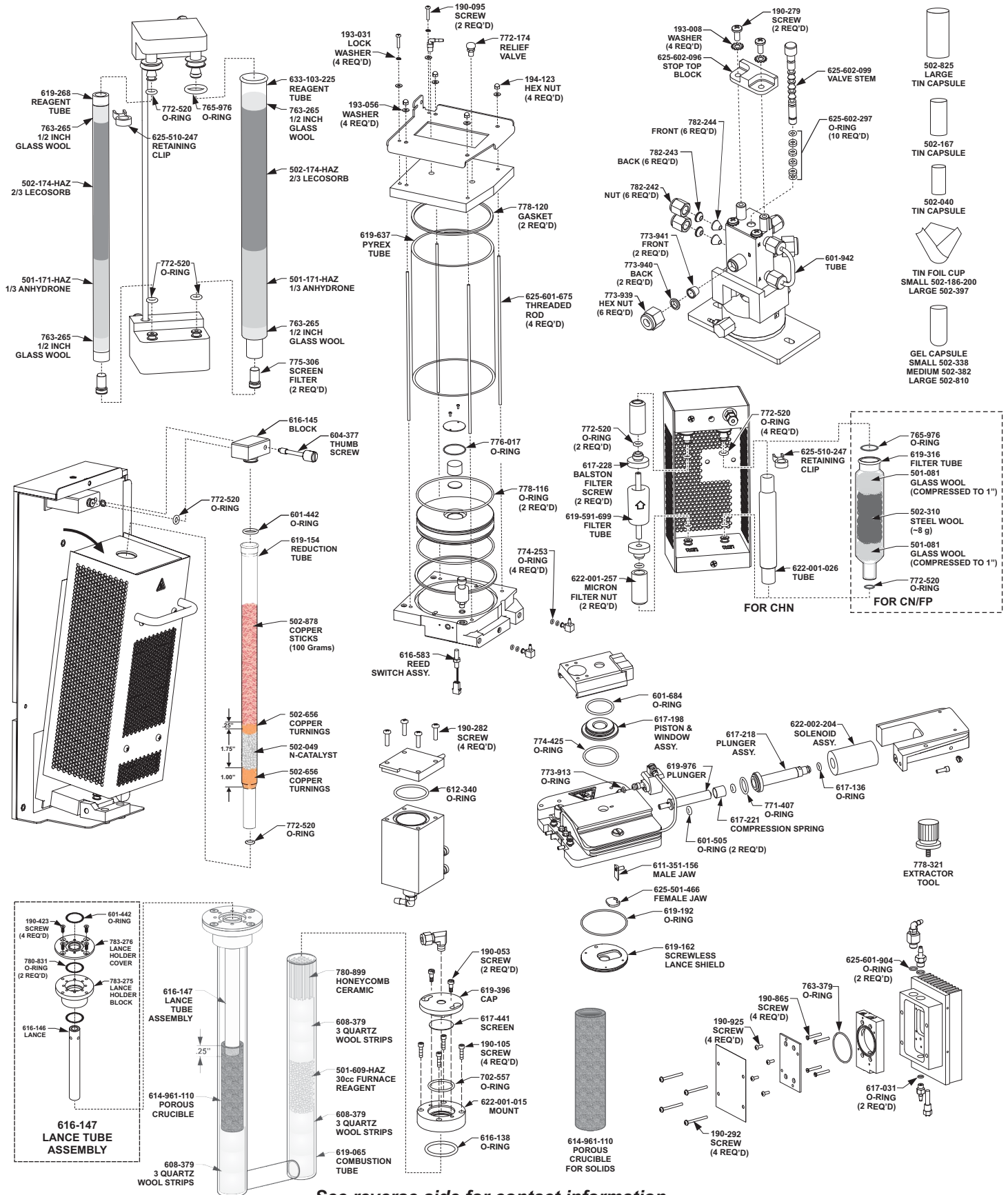

See reverse side for contact information

**GENERAL COMBUSTION SUPPLIES**

501-171-HAZ Anhydrous 454 g (1 lb.) bottle  
 502-705 Copper Sticks 100 g ampule  
 502-878 Copper Sticks 100 g bottle  
 502-656 Copper Turnings 60 g bottle  
 501-081 Glass Wool 454 g (1 lb.) box  
 763-265 Glass Wool 227 g (0.5 lb.) package  
 502-174-HAZ Lecosorb 500 g bottle  
 502-049 N-Catalyst 50 g bottle  
 608-379 Quartz Wool Strips 10/pkg  
 502-310 Steel Wool 454 g (1 lb.)  
 501-609-HAZ Furnace Reagent  
 625-602-470 Ballast C-Flex  
 Replacement Assembly

**CAPSULES AND CRUCIBLES**

502-338 Gel Capsule, Small 400/pkg  
 502-382 Gel Capsule, Medium 400/pkg  
 502-810 Gel Capsule, Large 400/pkg  
 614-961-110 Porous Crucibles for solids 10/pkg  
 617-605 Porous Crucibles for liquids 10/pkg  
 502-040 Tin Capsules, Small 100/bottle  
 502-040-100 Tin Capsules, Small 1000/bottle  
 502-167 Tin Capsules, Medium 100/bottle  
 502-825 Tin Capsules, Large 50/bottle  
 502-186-200 Tin Foil Cups, Small 100/bottle  
 502-186-100 Tin Foil Cups, Small 1000/bottle  
 502-397 Tin Foil Cups, Large 100/bottle  
 502-397-400 Tin Foil Cups, Large 400/bottle

**OPERATION ACCESSORIES**

502-007 Tube Cleaner  
 601-981 Wire Brush  
 616-152 Crucible Extractor Tool  
 775-306 Secondary Filter, 10 micron  
 775-307 Filter Tool, Thumbscrew  
 502-023 Funnel Quick Disc  
 778-321 Lance Extraction Tool  
 502-213 Leak Detection Solution  
 762-515 O-ring Tool - Removal  
 616-513 O-ring Tool - Installation  
 619-591-699 Particle Filter  
 604-398 Sample Cup Holder, Large  
 604-373 Sample Cup Holder, Small  
 778-405 10-Sample Storage Block  
 501-614 Spatula  
 619-180-110 Stackable Carousel Assembly  
 502-028 Tweezers  
 604-378 Tweezers, Curved (SST)  
 501-241 Vacuum Grease  
 619-380 Vacuum Cleaner Attachment Assembly  
 622-002-516 Bypass Plate

**COMBUSTION TUBES AND GLASSWARE**

601-390 Glass Filter Tube (wide mouth top, small bottom)  
 requires one (1) 765-976 Top O-ring and one (1)  
 772-520 Bottom O-ring for sealing  
 622-001-026 Glass Filter Tube (small mouth top and bottom)  
 requires 772-520 O-rings for sealing  
 619-268 Reagent Tube, requires 772-520 O-rings for sealing  
 619-154 Reduction Tube, requires 601-442 O-rings for sealing  
 780-899 Honeycomb Ceramic Stop  
 619-065 Combustion Tube  
 617-441 Screen Filter  
 633-103-225 Reagent Tube, requires 765-976 Top O-ring  
 and 772-520 Bottom O-ring for sealing

\*Values vary—contact LECO for current levels.

NOTE: Part numbers and standards' values may change.  
 Consult LECO for latest information.

**NATURAL MATRIX SET-UP STANDARDS**

Part No.	Description	% C	% H	% N	% S	Contents
501-563-150	Corn Flour	—	—	0.8–1.6	—	50 g
502-055	Orchard Leaves	44.0–52.0	5.7–6.5	2.0–2.8	0.15–0.25	20 g
502-082	Tobacco Leaves	35.0–47.0	4.0–7.0	2.0–4.0	0.3–0.8	20 g
502-932	Corn Gluten	51.0–53.0	7.0–7.5	11.0–12.0	0.75–1.0	50 g
502-273	Alfalfa	45.0–47.0	5.5–6.5	2.5–5.0	0.25–0.35	50 g
502-692	Wheat Flour	44.0–46.0	6.0–7.0	2.5–3.5	0.15–0.25	50 g
502-906	Barley	45.0–47.0	6.0–7.0	1.0–3.0	0.10–0.20	50 g
502-907	Rice Flour	43.0–45.0	6.0–7.0	1.0–3.0	0.10–0.20	50 g

**PURE CHEMICAL SET-UP STANDARDS**

Part No.	Description	% C	% H	% N	% O	Contents
502-688	Nicotinic Acid	58.53	4.09	11.38	—	15 g
502-896	EDTA	40.80–41.20	5.46–5.54	9.52–9.60	—	50 g
502-911	Glycine	32.00	6.71	18.66	42.63	50 g
502-642	Phenylalanine	65.4	6.7	8.5	—	50g

**COAL AND COKE REFERENCE MATERIALS**

Part No.	Description	% Sulfur	% C	% H	% N	Contents
502-680	Coal Prox Plus Low	~0.3	~81.0	~4.0	~1.0	50 g
502-681	Coal Prox Plus Med.	~1.3	~78.0	~5.0	~1.5	50 g
502-682	Coal Prox Plus High	~0.5	~75.0	~5.0	~1.5	50 g
502-683	Met Coke Prox Plus	~0.75	~87.0	~0.3	~1.0	50 g
502-684	Pet Coke Prox Plus	~5.5	~87.0	~3.6	~1.5	50 g

**CERTIFIED REFERENCE MATERIALS**

Part No.	Description	% S	% C	% H	% N	Contents
502-901	Mineral Oil CRM	—	~86.0	~13.80	—	118 ml (4 oz.)
502-850	Residual Fuel Oil	~3.0	~86.0	~10.0	~0.3	118 ml (4 oz.)
502-831	QAR CRM Coal 1	1.5	74.6*	4.8	1.7	50 g
502-832	QAR CRM Coal 2	0.25	70.0*	4.0	0.9	50 g
502-833	QAR CRM Coal 3	0.34	81.0*	4.01	1.1	50 g
502-834	QAR CRM Coal 4	0.30	68.5*	4.3	0.9	50 g
502-835	QAR CRM Coal 5	0.5	68.5*	5.0	1.7	50 g
502-836	QAR CRM Coal 6	3.99	70.2*	4.9	1.3	50 g
502-837	QAR CRM Coal 7	3.26	72.6*	4.9	1.4	50 g
502-838	QAR CRM Coal 8	0.7	68.5*	4.9	1.2	50 g
502-839	QAR CRM Coal 9	2.1	77.5*	5.1	1.5	50 g

\*For information purposes only.