

LECO RHEN602

EMPOWERING RESULTS

Consumables & Spare Parts Reference Card

Note: Part numbers and standards' values may change. Consult LECO for the latest information.

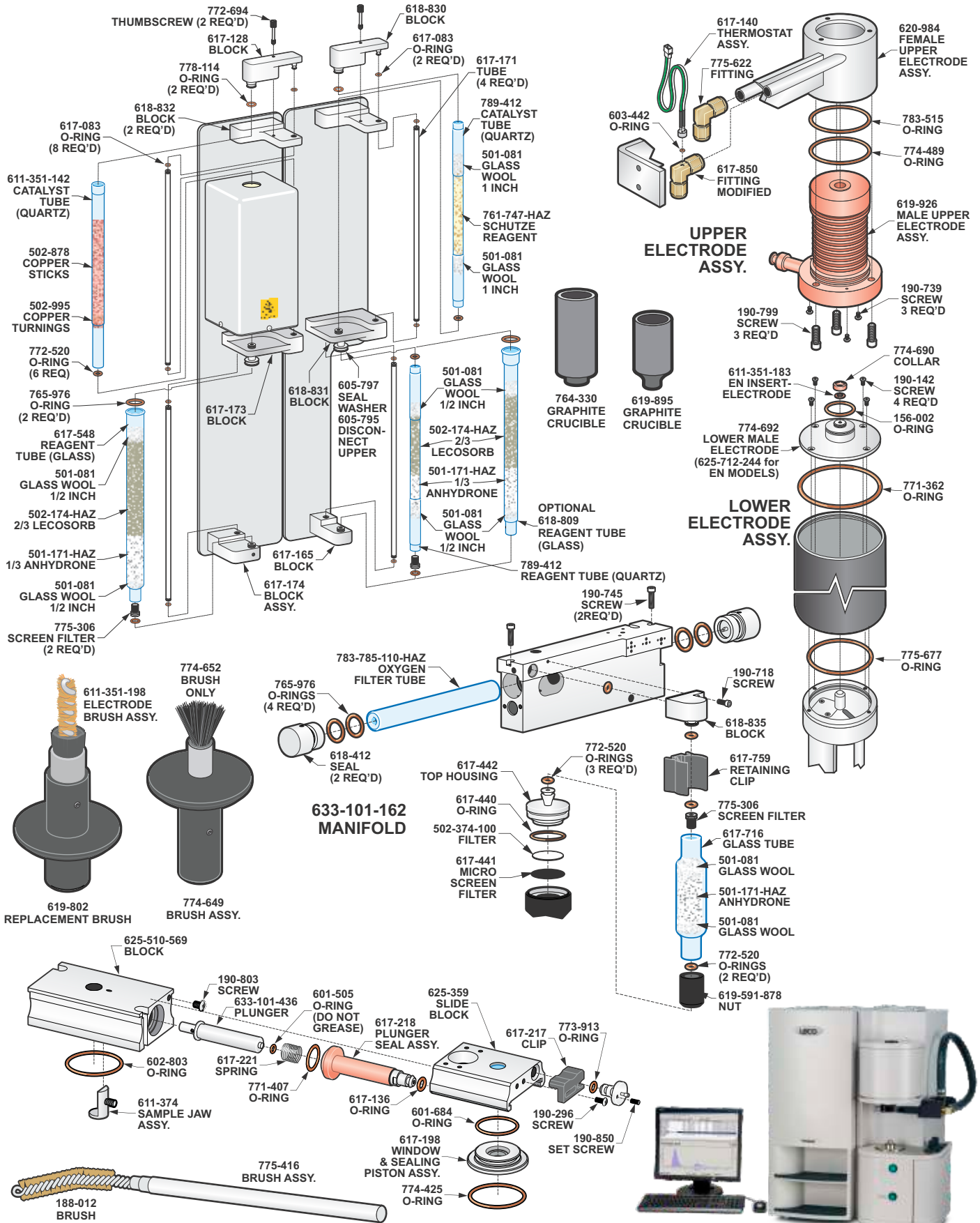

FUSION SUPPLIES

501-598	Etchable Nibbled Nickel 100 g bottle
501-073	Graphite Powder 100 g bottle
502-040	Large Tin Capsule 100/bottle
611-351-180	Lower Electrode Tip (for 764-330 Crucibles with Automation)
611-351-183	Lower Electrode Tip (for 764-330 Crucibles without Automation)
619-896	Lower Electrode Tip (for 619-895 Crucibles)
502-822	Nickel Capsule 100/bottle
502-345	1.5 g Nickel Baskets Ultra High Purity 100/bottle
502-344	1.0 g Nickel Baskets Ultra High Purity 100/bottle
501-059	Small Tin Capsule 100/bottle
761-744	Molecular Sieve Assembly

CATALYSTS AND REAGENTS

501-171-HAZ	Anhydrous 454 g (1 lb.) bottle
502-705	Copper Sticks 100 g ampule
502-878	Copper Sticks 100 g bottle
502-995	Copper Turnings 60 g bottle
501-081	Glass Wool 454 g (1 lb.) box
501-073	Graphite Powder 100 g bottle
502-174-HAZ	Lecosorb 500 g bottle, 20-30 mesh
502-176-HAZ	Lecosorb 500 g bottle, 8-20 mesh
761-747-HAZ	Schutze Reagent

OPERATION ACCESSORIES

766-053	Crucible Tweezers
766-646	Air Filter Coating
775-306	Secondary Filter, 10 micron
775-307	Screen Filter Removal Tool (Thumbscrew)
625-711-599	Lubricool Cooling Agent
764-078	One gram Weight
783-785-110-HAZ	Replacement Tube for 783-786 Kit
760-138	Sample Tweezers (Straight)
501-241	Vacuum Grease
767-473	Utility Funnel
620-760	Vacuum Filter (Ash Vac)
618-809	Medium Reagent Tube (Glass)

MAINTENANCE PARTS KITS

104-151	RHEN602 Maintenance Parts Kit
---------	-------------------------------

Please Note: Quartz Tubes are typically utilized for higher temperature applications (i.e. catalyst tubes). Glass reagent/filter tubes are designed for lower temperature applications. Glass tubes should not be used in place of quartz tubes.

REFERENCE MATERIALS AND STANDARDS

Current part numbers and values for LECO Reference Materials and Standard (209-296) can be found at <https://www.leco.com/consumables>