

Note: Part numbers and standards' values may change. Consult LECO for the latest information.

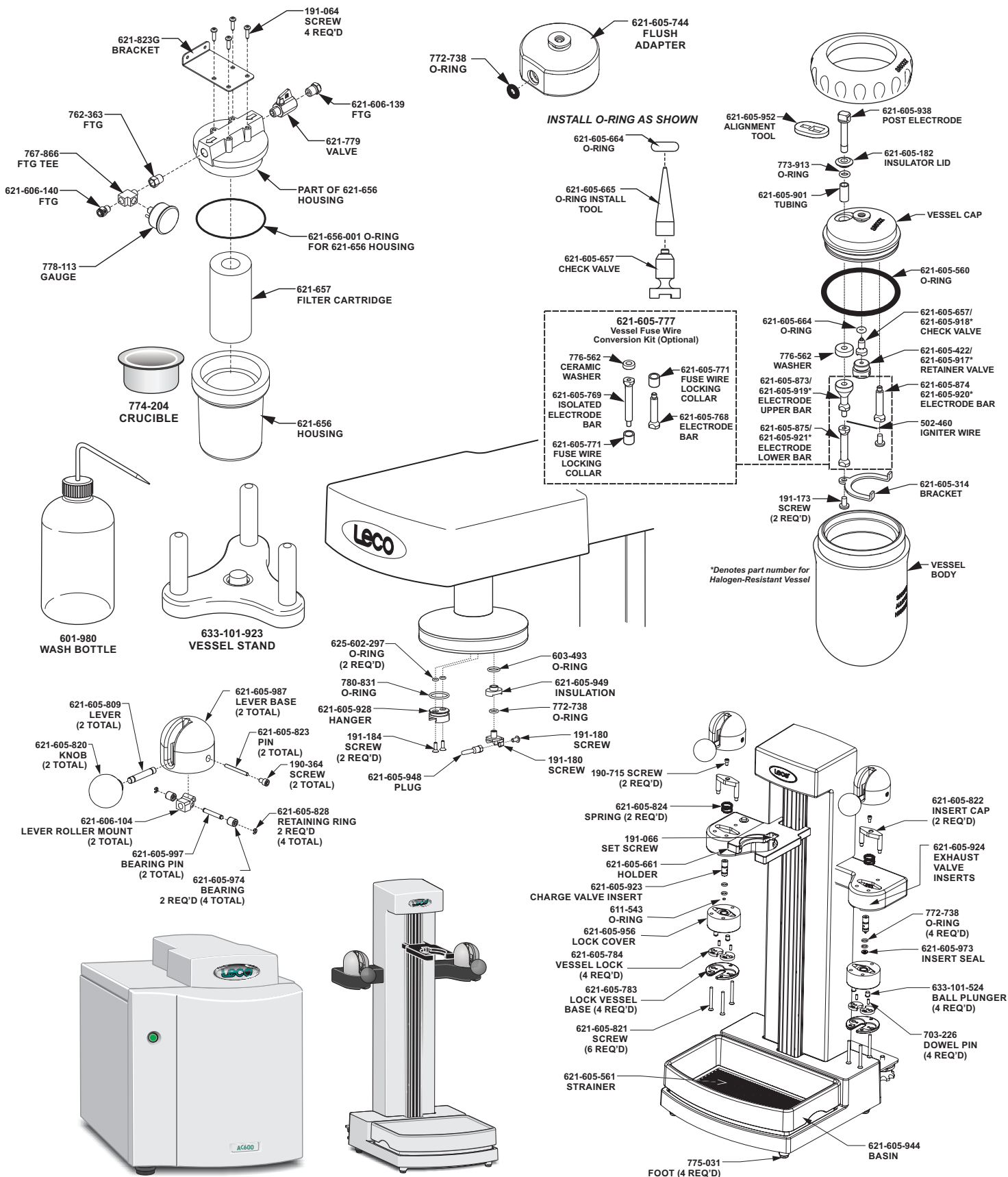

See reverse side for contact information

GENERAL COMBUSTION SUPPLIES

774-649 Cleaning Brush Assembly
774-204 Crucible 10/pkg.
502-461 Cotton Thread Fuse, 10 cm, 375/pkg
502-462 Fuse Wire, 10 cm, 375/pkg
621-605-803 Fixed Wire Igniter Assembly, 5/pkg
502-460 Fixed Wire Igniter

OPERATION ACCESSORIES

501-241 Vacuum Grease (Silicone)
633-101-923 AC600 Vessel Holder
621-657 Filter Cartridge, 1 micron
621-605-744 Flush Adapter
762-515 O-Ring Removal Tool
776-978 Glass Scoop
502-051 Tweezers, Curved Fine Point
621-605-517 Vessel Lid Removal Tool
621-605-750 Vessel Tool Kit

OPTIONS

751-350-110 Electronic Balance
621-322 Pellet Press
601-483-100 Paper (2400 sheets)
621-606-160 External Chiller Kit, 120V, 60 Hz (sized for single AC600)
621-606-162 External Chiller Kit, 240V, 50 Hz (sized for single AC600)
621-606-164 External Chiller Kit, 120V, 60 Hz (sized for dual AC600)
621-606-166 External Chiller Kit, 240V, 50 Hz (sized for dual AC600)
619-592-407 Compressed Air Regulator
619-995 Bar Code Scanner USB
621-453-110 Deskjet Printer Kit
621-605-958 AC600 Prep Station
621-605-686 O-Ring Pack for Vessel
621-605-687 O-Ring Pack for Prep Station
621-605-979 Halogen Resistant Combustion Vessel II
621-605-978 Standard Combustion Vessel II

O-RINGS

611-543 Prep Station Nipple Charge
621-605-560 Vessel Cap
621-605-664 Check Valve
621-605-973 Seal Insert Exhaust
772-738 Prep Station Valve Inserts
773-913 Electrode Post
776-562 Ceramic Washer
621-656-001 Water Filter Housing

REFERENCE MATERIALS

502-892 Benzoic Acid Tablets, 70/pkg
502-682 Coal Prox Plus (High), 50 g/bottle
502-901 Mineral Oil 4 oz/bottle

**Values vary—contact LECO for current levels.*

NOTE: Part numbers and standards' values may change.

Consult LECO for latest information.